



Retail For Lease

1920 Eglinton Avenue East











Overview

1920 Eglinton Avenue East consists of 9,302 SF of retail space in the grocery anchored Eglinton Corners Shopping Centre at Eglinton & Warden. The property is zoned for a variety of retail uses, including daycares, animal hospitals, pet stores, full service restaurants and many more. With ample exposure to Eglinton Avenue East, this prime opportunity features generous ceiling heights, dedicated access to shipping & receiving, patio potential and is anchored by Adonis, Best Buy, Boston Pizza, DSW, HomeSense, Sport Chek and The Brick.

Demographics

	1km	3km	5km
 Population	3,089	123,550	377,926
 Daytime Population	8,094	122,470	337,140
 Growth Rate (2015-2020)	3%	5%	6%
 Avg. Household Income	\$68,691	\$82,665	\$89,337
 Median Age	38	41	40
 Education (Bachelor Degree or Higher)	21%	21%	25%

Source: Statistics Canada, 2021

Property Details

SIZE | 9,302 SF

AVAILABLE | 30 days' notice

TERM | 5 - 10 Years

NET RENT | \$25.00 PSF

ADDITIONAL RENT | \$11.14 PSF (EST. 2021)

Highlights

- Located on “The Golden Mile” in a 200,000 SF grocery anchored site
- Anchored by Adonis, The Brick, Sport Chek, HomeSense, Best Buy and RBC
- Premium retail space with ample on-site parking
- Significant frontage and exposure to Eglinton Avenue East
- Pylon signage available
- Located directly on the future Eglinton LRT Line

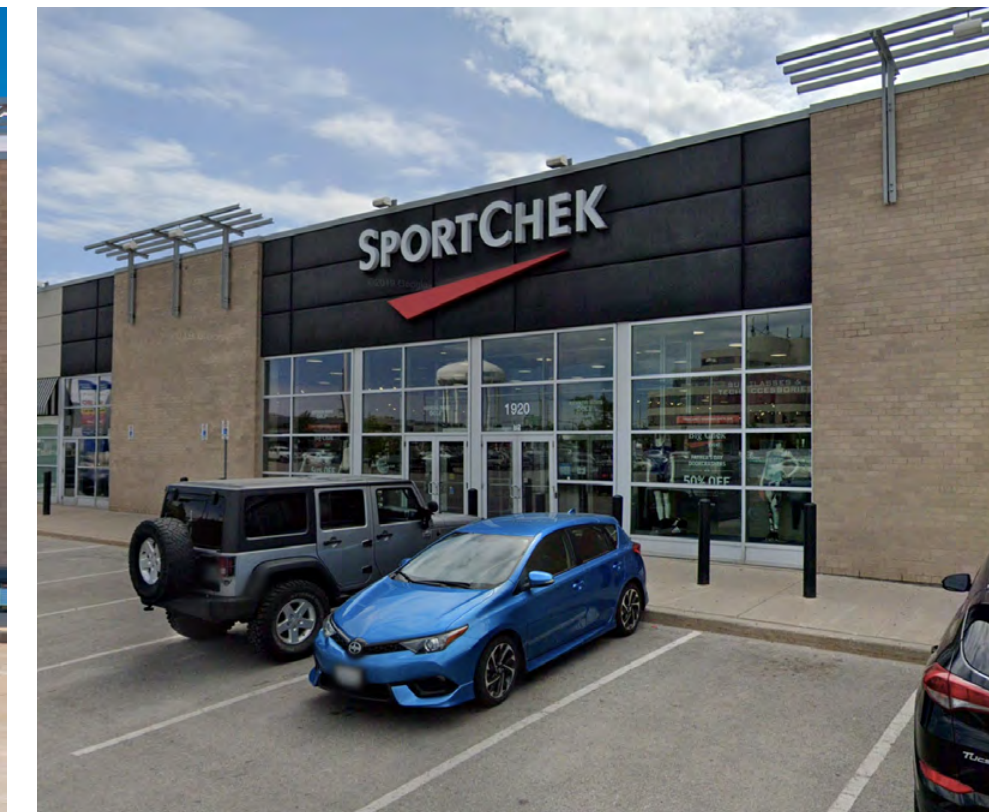



Neighbouring Retailers & Future Developments

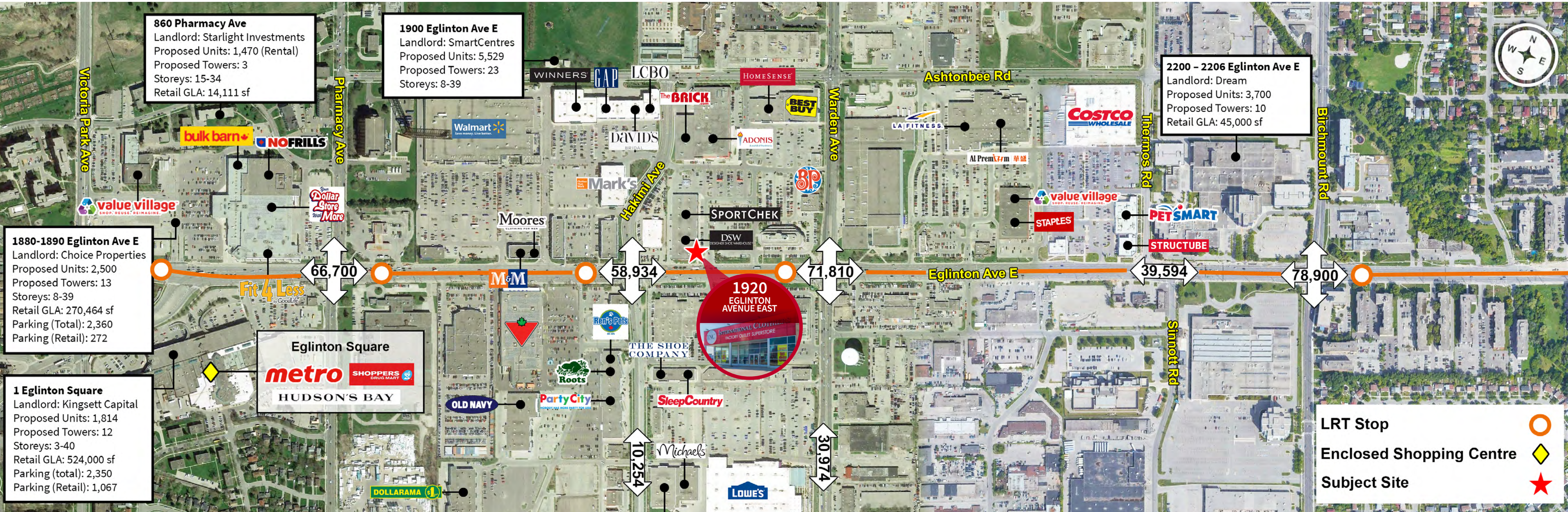

Site Plan

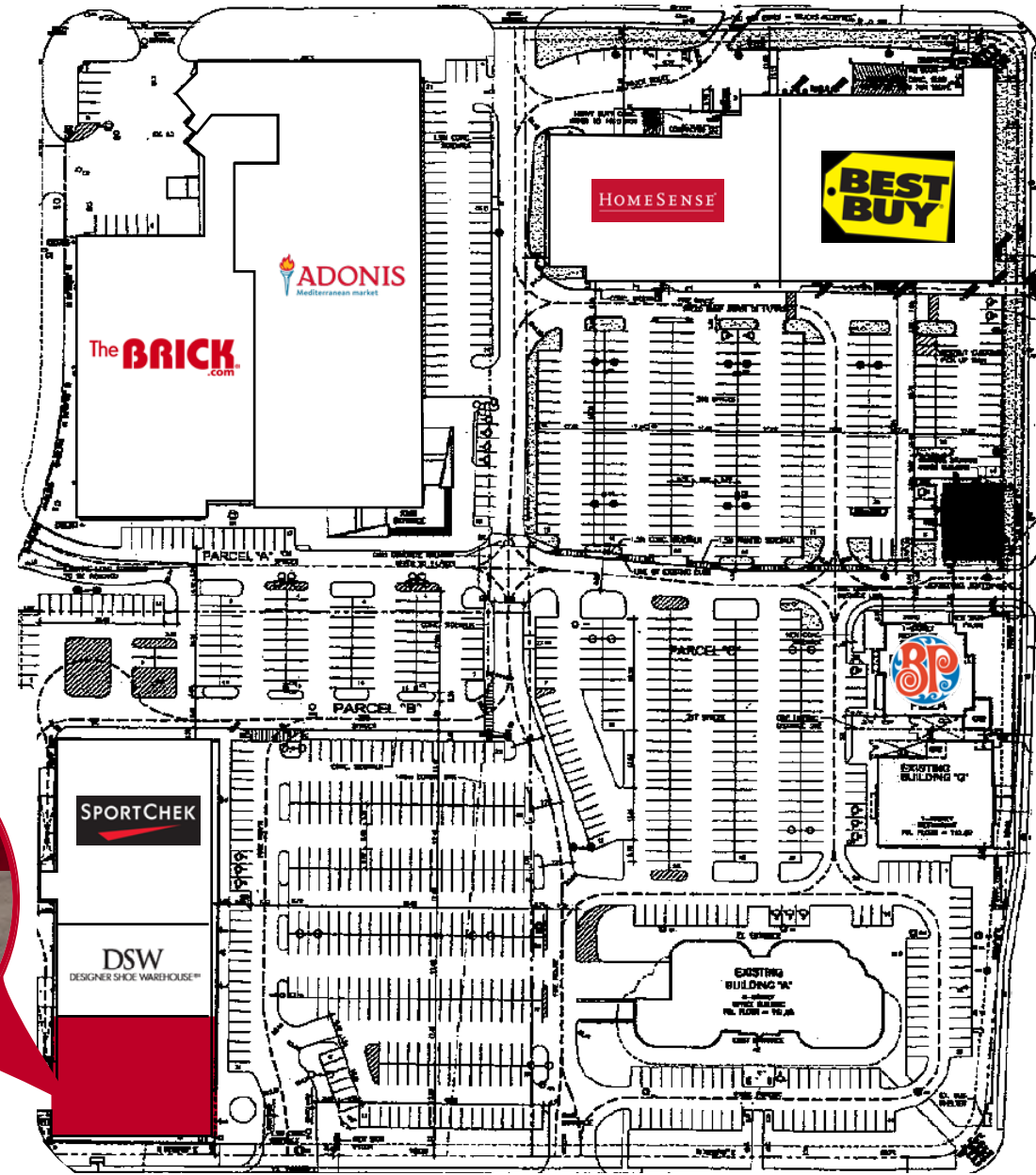

Floor Plan

GROUND FLOOR | 9,302 SF (Divisible)

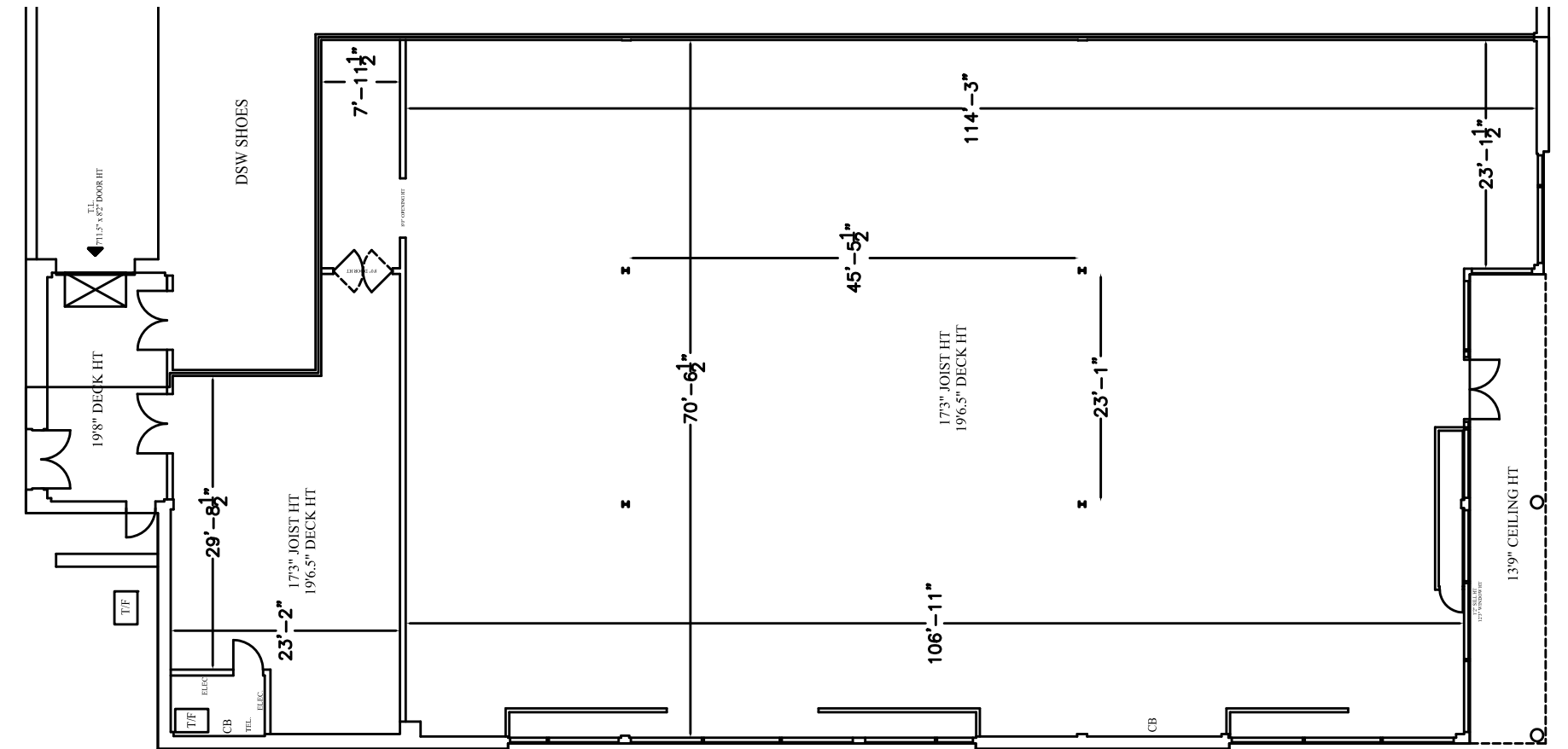

EGLINTON AVENUE EAST

FOR LEASE | 1920 EGLINTON AVENUE EAST

Brandon Gorman*

Senior Vice President

+1 416 855 0907

Brandon.Gorman@am.jll.com

Graham Smith*

Senior Vice President

+1 416 855 0914

Graham.Smith@am.jll.com

Austin Jones*

Sales Representative

+1 416 855 0939

Austin.Jones@am.jll.com



Although information has been obtained from sources deemed reliable, neither Owner nor JLL makes any guarantees, warranties or representations, express or implied, as to the completeness or accuracy as to the information contained herein. Any projections, opinions, assumptions or estimates used are for example only. There may be differences between projected and actual results, and those differences may be material. The Property may be withdrawn without notice. Neither Owner nor JLL accepts any liability for any loss or damage suffered by any party resulting from reliance on this information. If the recipient of this information has signed a confidentiality agreement regarding this matter, this information is subject to the terms of that agreement. ©2021 Jones Lang LaSalle IP, Inc. All rights reserved. *Sales Representative.